

taylor  
brammer

abu dhabi

austinmer

sydney

218 Oxford Street, Woolahra, NSW, Australia, 2025

tel: (02) 9387 8855 fax: (02) 9387 8155

e: sydney@taylorbrammer.com.au

taylor brammer landscape architects Pty Ltd

ABN 61 028 724 989

LEGEND

SITE BOUNDARY

EXISTING TREE RETAINED  
REFER ARBORISTS REPORT

H9-120

H9-120

EXISTING TREE REMOVED  
REFER ARBORISTS REPORT

DEAD TREE REMOVED PRIOR

PROPOSED  
UNDERSTORY PLANTING

EXISTING PLANTING  
TO REMAIN

EXTENT OF  
EXISTING FAIRWAY

ROUGH

PROPOSED FAIRWAY

PROPOSED PUTTING  
GREEN

BUNKER

SITE ROCK

EXISTING PATH  
RETAINED

PROPOSED PATH

EXISTING CONTOUR

HOLE NUMBER

EXISTING / PROPOSED DAM

Issue

Comments

Date

A

DA SUBMISSION

21.03.2011

B

REVISED DA SUBMISSION

07.12.2011

C

REVISED DA SUBMISSION

30.04.2012

PROJECT

KILLARA GOLF COURSE

JOB NUMBER

10-1295

0

2

4

8

12m

7

DRAWING TITLE

DETAIL TREE REMOVAL AND  
RETENTION PLAN  
BRANFIELD Paddock

DRAWN

AL

CHECKED

MT

DATE CREATED

30.04.2012

SCALE

1:200 @ A1

DRAWING NUMBER

LA04-10

ISSUE

C



[illegible][illegible][illegible]



LA04-12

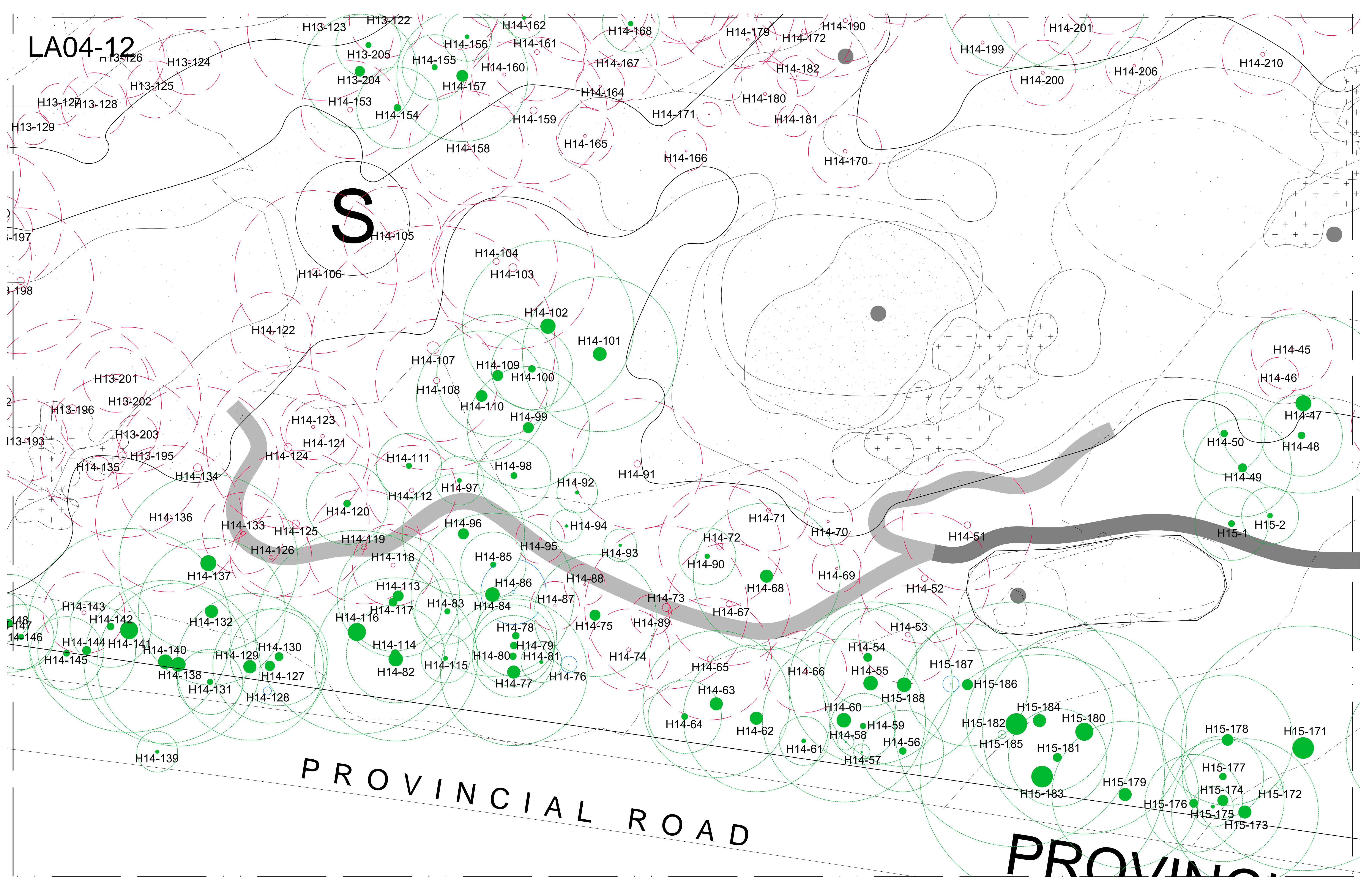

taylor  
brammer

ecu dhadi

austrmer

sydney

218 Oxford Street, Woolahra, NSW, Australia, 2025

tel: (02) 9387 8855 fax: (02) 9387 8155

e: sydney@taylorbrammer.com.au

218 Oxford Street, Woolahra, NSW, Australia, 2025

tel: (02) 9387 8855 fax: (02) 9387 8155

e: sydney@taylorbrammer.com.au

218 Oxford Street, Woolahra, NSW, Australia, 2025

tel: (02) 9387 8855 fax: (02) 9387 8155

e: sydney@taylorbrammer.com.au

LEGEND										Issue		Comments		Date		PROJECT		DRAWING TITLE			
	SITE BOUNDARY			EXISTING TREE REMOVED REFER ARBORISTS REPORT			EXISTING PLANTING TO REMAIN			PROPOSED FAIRWAY			SITE ROCK			EXISTING CONTOUR		KILLARA GOLF COURSE		DETAIL TREE REMOVAL AND RETENTION PLAN BRANFIELD PADDOCK	
	EXISTING TREE RETAINED REFER ARBORISTS REPORT			DEAD TREE REMOVED PRIOR			EXTENT OF EXISTING FAIRWAY			PROPOSED PUTTING GREEN			EXISTING PATH RETAINED			HOLE NUMBER					
				PROPOSED UNDERSTORY PLANTING			ROUGH			BUNKER			PROPOSED PATH			EXISTING / PROPOSED DAM		JOB NUMBER		DATE CREATED	
																		10-1295		30.04.2012	
																		DRAWING NUMBER		SCALE	
																		LA04-12		1:200 @ A1	
																				C	
																		0 2 4 8 12m			



LA04-13

14

218 Oxford Street, Woollahra, NSW, Australia, 2025  
tel: (02) 9387 8855 fax: (02) 9387 8155  
e: [sydney@taylorbrammer.com.au](mailto:sydney@taylorbrammer.com.au)

## LEGEND

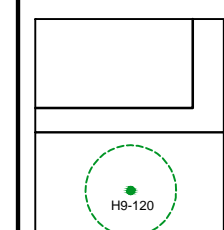

SITE BOUNDARY

EXISTING TREE RETAINED  
REFER ARBORISTS REPORT

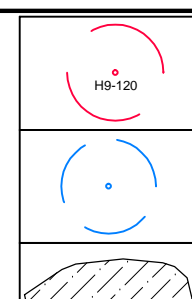

EXISTING TREE REMOVED  
REFER ARBORISTS REPORT

DEAD TREE REMOVED PRIOR

PROPOSED  
UNDERSTORY PLANTING

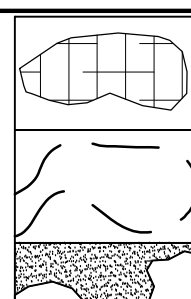

EXISTING PL  
TO REMAIN

EXTENT OF

ROUGH

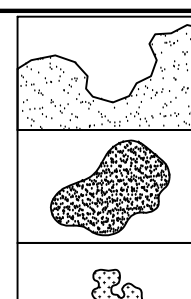

PROPOSED FAIRWAY

PROPOSED PUTTING GREEN:

BUNKER

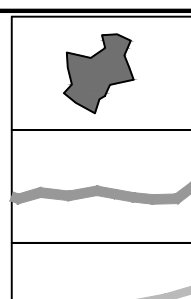

SITE ROCK

EXISTING PATH

PROPOSED PATH

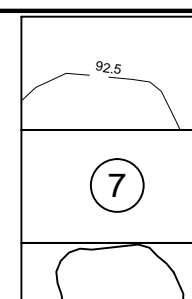

EXISTING CONTOUR

HOLE NUMBER

EXISTING / PROPOSED DAM
-------------------------

Issue	Comments
A	DA SUBMISSION
B	REVISED DA SUBMISSION



ED DAM

Date \_\_\_\_\_

PROJECT

KILLARA GOLF COURSE

JOB NUMBER  
10-129S

Diagram of a beam of length 12m. The beam is divided into three segments: 0 to 4m, 4 to 8m, and 8 to 12m. A uniformly distributed load of 2 kN/m is applied from 0 to 4m. A point load of 8 kN is applied at 8m.

DRAWING TITLE

DETAIL TREE REMOVAL AND  
RETENTION PLAN  
BRANFIELD PADDOCK

DRAWN	CHECKED	DATE CREATED	SCALE
AL	MT	30.04.2012	1:200 @ A1

DRAWING NUMBER  
LA04-13

ISSUE  
C



LA04-14

15

H10-40  
H13-88  
H10-39  
H10-38  
H10-37  
H13-89  
H13-90  
H13-91  
H13-92  
H13-93  
H13-94  
H13-95  
H14-235  
H14-236  
H14-237  
H14-238  
H14-239  
H14-240  
H14-241  
H14-242  
H14-243  
H14-244  
H14-245  
H10-34  
H10-32  
H10-31  
H10-33  
H10-30  
H10-27  
H10-29  
H15-30  
H10-26  
H10-25  
H10-24  
H10-28  
H15-28  
H15-29  
H15-31  
H15-32  
H15-33  
H15-34  
H10-19  
H10-20  
H10-21  
H10-22  
H10-18  
H10-17  
H10-16  
H10-15  
H15-21  
H15-22  
H15-23  
H15-24  
H15-25  
H15-27  
H10-23  
H10-191  
H10-192  
H10-193  
H10-194  
H10-195  
H10-196  
H16-8  
H16-7  
H16-6  
H16-5  
H16-4  
H16-3  
H16-2  
H16-1  
H10-197  
H10-1  
H16-123  
H10-123

taylor  
brammer

ecu dhadi  
austmer  
sydney

218 Oxford Street, Woolahra, NSW, Australia, 2025  
tel: (02) 9387 8855 fax: (02) 9387 8155  
e: sydney@taylorbrammer.com.au

218 Oxford Street, Woolahra, NSW, Australia, 2025  
tel: (02) 9387 8855 fax: (02) 9387 8155  
e: sydney@taylorbrammer.com.au

LEGEND

SITE BOUNDARY

EXISTING TREE RETAINED  
REFER ARBORISTS REPORT

DEAD TREE REMOVED PRIOR  
REFER ARBORISTS REPORT

PROPOSED UNDERSTORY PLANTING

EXISTING TREE REMOVED  
REFER ARBORISTS REPORT

DEAD TREE REMOVED PRIOR  
REFER ARBORISTS REPORT

PROPOSED UNDERSTORY PLANTING

EXISTING PLANTING  
TO REMAIN

EXTENT OF  
EXISTING FAIRWAY

ROUGH

PROPOSED FAIRWAY

PROPOSED PUTTING  
GREEN

BUNKER

SITE ROCK

EXISTING PATH  
RETAINED

PROPOSED PATH

EXISTING CONTOUR

HOLE NUMBER

EXISTING / PROPOSED DAM

EXISTING CONTOUR

HOLE NUMBER

EXISTING / PROPOSED DAM

PROJECT

KILLARA GOLF COURSE

JOB NUMBER

10-1295

0 2 4 8 12m

DRAWING TITLE

DETAIL TREE REMOVAL AND  
RETENTION PLAN  
BRANFIELD PADDOCK

DRAWING NUMBER

LA04-14

SCALE

1:200 @ A1

C







The map displays a proposed road layout with 30 numbered points (H15-120 to H15-149) and a 'PROVINCIAL ROAD' label. The points are distributed across the map, with some points (H15-120, H15-121, H15-122, H15-123, H15-124, H15-125, H15-126, H15-127, H15-128, H15-129, H15-130, H15-131, H15-132, H15-133, H15-134, H15-135, H15-136, H15-137, H15-138, H15-139, H15-140, H15-141, H15-142, H15-143, H15-144, H15-145, H15-146, H15-147, H15-148, H15-149) marked with green dots and others (H15-120, H15-121, H15-122, H15-123, H15-124, H15-125, H15-126, H15-127, H15-128, H15-129, H15-130, H15-131, H15-132, H15-133, H15-134, H15-135, H15-136, H15-137, H15-138, H15-139, H15-140, H15-141, H15-142, H15-143, H15-144, H15-145, H15-146, H15-147, H15-148, H15-149) marked with blue dots. The 'PROVINCIAL ROAD' label is located in the lower right quadrant of the map.

<div><div><div>taylor brammer</div><div><div>218 Oxford Street, Woolahra, NSW, Australia, 2025</div><div>tel: (02) 9387 8855 fax: (02) 9387 8155</div><div>e: sydney@taylorbrammer.com.au</div></div></div><div><div>acut drcal</div><div>austimr</div><div>sydney</div></div><div><div>taylor brammer landscape architects Pty Ltd</div><div>abn 61 068 724 955</div></div></div>		<div>LEGEND</div> <div><div><div><div></div><div>SITE BOUNDARY</div></div><div><div><div><div></div><div>EXISTING TREE REMOVED REFER ARBORISTS REPORT</div></div><div><div><div><div></div><div>DEAD TREE REMOVED PRIOR</div></div><div><div><div><div></div><div>PROPOSED UNDERSTORY PLANTING</div></div></div></div></div><div><div><div><div></div><div>EXISTING TREE RETAINED REFER ARBORISTS REPORT</div></div></div></div></div></div></div></div></div>		<div><div><div><div><div></div><div>EXISTING TREE REMOVED REFER ARBORISTS REPORT</div></div><div><div><div><div></div><div>DEAD TREE REMOVED PRIOR</div></div><div><div><div><div></div><div>PROPOSED UNDERSTORY PLANTING</div></div></div></div></div><div><div><div><div></div><div>EXISTING TREE RETAINED REFER ARBORISTS REPORT</div></div></div></div></div></div></div></div>		<div><div><div><div><div></div><div>EXISTING PLANTING TO REMAIN</div></div><div><div><div><div></div><div>EXTENT OF EXISTING FAIRWAY</div></div><div><div><div><div></div><div>ROUGH</div></div></div></div></div><div><div><div><div></div><div>PROPOSED FAIRWAY</div></div><div><div><div><div></div><div>PROPOSED PUTTING GREEN</div></div><div><div><div><div></div><div>BUNKER</div></div></div></div></div></div></div></div></div></div></div></div>		<div><div><div><div><div></div><div>SITE ROCK</div></div><div><div><div><div></div><div>EXISTING PATH RETAINED</div></div><div><div><div><div></div><div>PROPOSED PATH</div></div></div></div></div></div></div></div></div>		<div><div><div><div><div></div><div>EXISTING CONTOUR</div></div><div><div><div><div></div><div>HOLE NUMBER</div></div><div><div><div><div></div><div>EXISTING / PROPOSED DAM</div></div></div></div></div></div></div></div></div>		<div><div><div><div><div>Issue</div><div>Comments</div><div>Date</div></div><div><div><div>A</div><div>DA SUBMISSION</div><div>21.10.2011</div></div><div><div>B</div><div>REVISED DA SUBMISSION</div><div>07.12.2011</div></div><div><div>C</div><div>REVISED DA SUBMISSION</div><div>30.04.2012</div></div></div></div><div><div><div></div></div></div></div></div>		<div><div><div><div><div>PROJECT</div><div>KILLARA GOLF COURSE</div></div><div><div><div>JOB NUMBER</div><div>19-1295</div></div><div><div><div>DRAWN</div><div>AL</div></div><div><div><div>CHECKED</div><div>MT</div></div></div><div><div><div>DATE CREATED</div><div>30.04.2012</div></div><div><div><div>SCALE</div><div>1:200 @ A1</div></div></div></div></div><div><div><div><div>DRAWING NUMBER</div><div>LA04-16</div></div><div><div><div>ISSUE</div><div>C</div></div></div></div></div></div></div></div></div>	
--	--	--	--	---	--	---	--	--	--	--	--	--	--	--	--

LA04-17

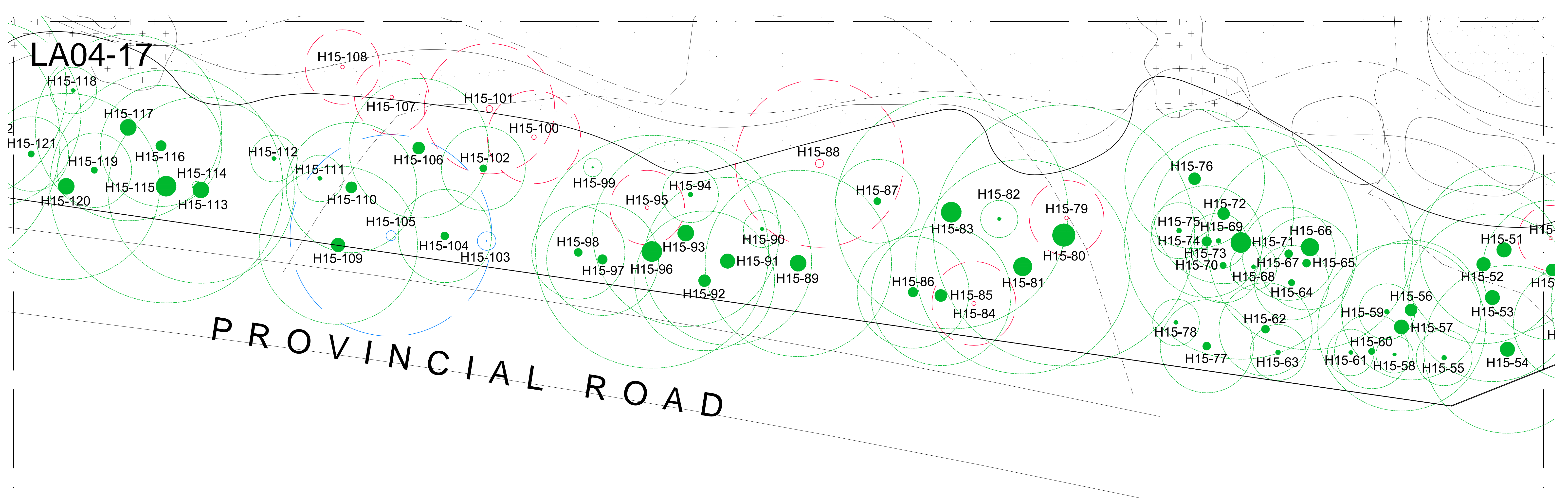

PROVINCIAL ROAD

LEGEND

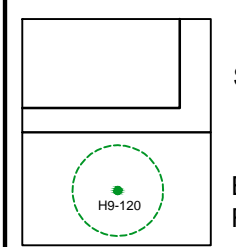

SITE BOUNDARY

EXISTING TREE RETAINED  
REFER ARBORISTS REPORT

EXISTING TREE REMOVED  
REFER ARBORISTS REPORT

DEAD TREE REMOVED PRIOR

PROPOSED  
UNDERSTORY PLANTING

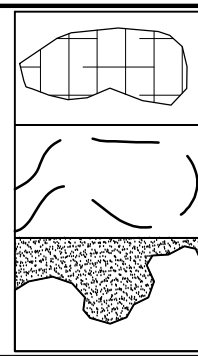

EXISTING PLANTING  
TO REMAIN

EXTENT OF  
EXISTING FAIRWAY

ROUGH

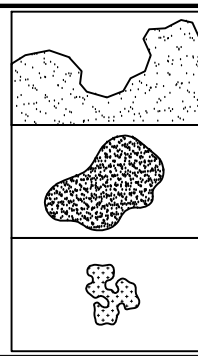

PROPOSED FAIRWAY

PROPOSED PUTTING  
GREEN

BUNKER

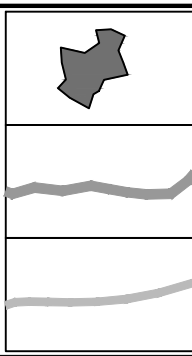

SITE ROCK

EXISTING PATH  
RETAINED

PROPOSED PATH

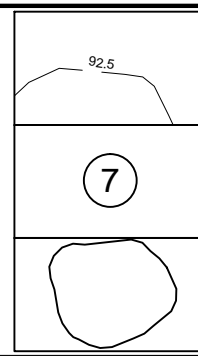

EXISTING CONTOUR

HOLE NUMBER

EXISTING / PROPOSED DAM

Issue	Comments	Date
A	DA SUBMISSION	21.03.2011
B	REVISED DA SUBMISSION	07.12.2011
C	REVISED DA SUBMISSION	30.04.2012

PROJECT
KILLARA GOLF COURSE
JOB NUMBER
10-1295
0 2 4 8 12m

DRAWING TITLE			
DETAIL TREE REMOVAL AND RETENTION PLAN BRANFIELD PADDOCK			
DRAWN	CHECKED	DATE CREATED	SCALE
AL	MT	30.04.2012	1:200 @ A1
DRAWING NUMBER			ISSUE
LA04-17			C



LA04-18

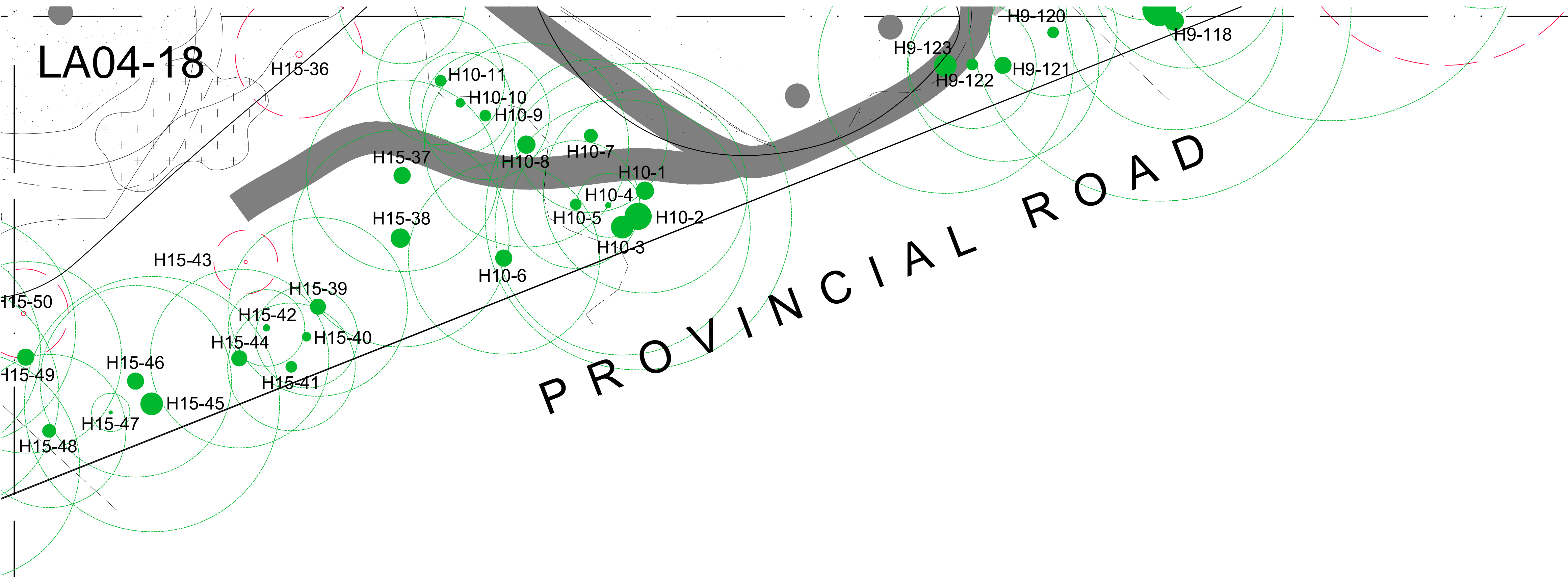

taylor  
brammer

ecu dhari  
austinner  
sydney

218 Oxford Street, Woolahra, NSW, Australia, 2025  
tel: (02) 9387 8855 fax: (02) 9387 8155  
e: sydney@taylorbrammer.com.au

taylor  
brammer

landscape architects  
sydney

LEGEND

SITE BOUNDARY

EXISTING TREE RETAINED  
REFER ARBORISTS REPORT

EXISTING TREE REMOVED  
REFER ARBORISTS REPORT

DEAD TREE REMOVED PRIOR

PROPOSED  
UNDERSTORY PLANTING

EXISTING PLANTING  
TO REMAIN

EXTENT OF  
EXISTING FAIRWAY

ROUGH

PROPOSED FAIRWAY

PROPOSED PUTTING  
GREEN

BUNKER

SITE ROCK

EXISTING PATH  
RETAINED

PROPOSED PATH

EXISTING CONTOUR

HOLE NUMBER

EXISTING / PROPOSED DAM

0 2 4 8 12m

JOB NUMBER  
10-1295

DRAWN  
AL

CHECKED  
MT

DATE CREATED  
30.04.2012

SCALE  
1:200 @ A1

DRAWING NUMBER  
LA04-18

ISSUE  
C

PROJECT  
KILLARA GOLF COURSE

DRAWING TITLE  
DETAIL TREE REMOVAL AND  
RETENTION PLAN  
BRANFIELD PADDOCK

Issue

Comments

Date

A

DA SUBMISSION

21.03.2011

B

REVISED DA SUBMISSION

07.12.2011

C

REVISED DA SUBMISSION

30.04.2012



